

ZONE	REV	DESCRIPTION	DATE	APPROVED

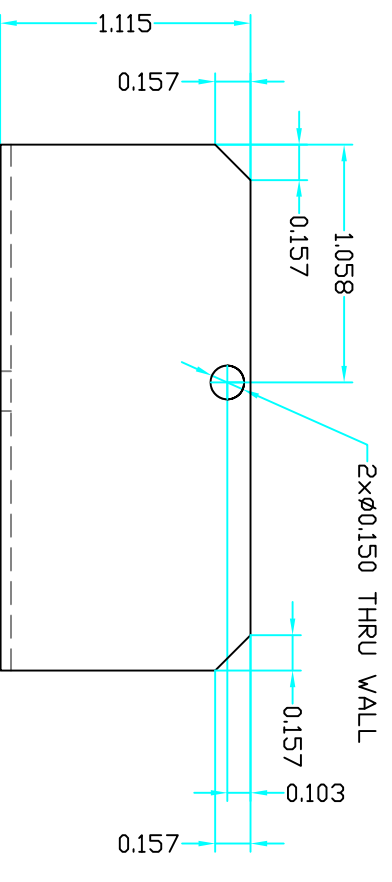
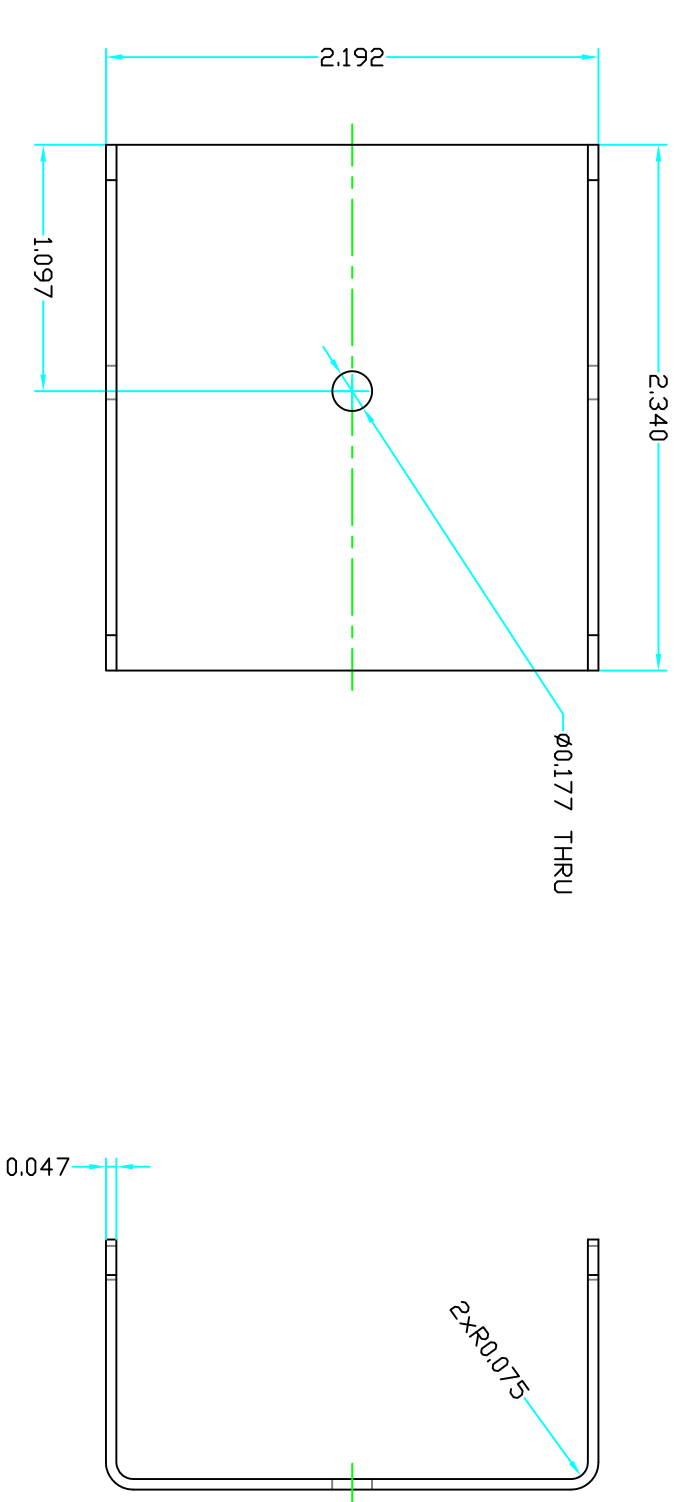

PART#	QTY	EA	COVER	NUMM 500-452	BLUE ANODIZED	5001100002 02
PART1	1	EA	COVER	NUMM 500-452	BLACK ANODIZED	5001000002 01

FINO/REF#	QTY	UM	PART NAME	MATERIAL	PART DESCRIPTION	REF. SHEET/DWG

UNLESS OTHERWISE SPECIFIED				PERMISSIBLE VARIATION IN INCH DIMENSIONS WITHOUT TOLERANCES			
1	2	3	4	5	6	7	8
12	TO 60	60 TO 180	OVER 180	12	12 TO 60	60 TO 180	OVER 180
±0.10	±0.13	±0.20	±0.30	±0.10	±0.15	±0.20	±0.30
±0.05	±0.07	±0.10	±0.15	±0.05	±0.07	±0.10	±0.15
±0.01	±0.02	±0.03	±0.05	±0.01	±0.02	±0.03	±0.05
±0.005	±0.01	±0.015	±0.02	±0.005	±0.01	±0.015	±0.02
±0.002	±0.005	±0.007	±0.01	±0.002	±0.005	±0.007	±0.01
±0.001	±0.002	±0.003	±0.005	±0.001	±0.002	±0.003	±0.005

1. DIMENSIONS ARE IN INCHES.
 2. MACHINE SURFACES TO BE FLAT, SQUARE, PARALLEL, & CONCENTRIC BELOW 12 & XX.
 3. WITHIN 200 FOR 3 INCHES OR 200 TIR AS APPLICABLE.
 4. BREAK ALL SHARP CORNERS AT X 45° CHAMFER.
 5. FILLETS SHOWN SHARP = .04 RAD.
 6. TAPPED HOLES UNF/TF CLASS 2B THREAD, MIN DEPTH 1.5 x DIA.
 7. CSNK BORED & REAMED HOLES 1/16 x 45°.
 8. CENTER PERMISSIBLE.
 9. ALL DIMENSIONS TO CENTER UNLESS OTHERWISE SPECIFIED.
 10. ALL WELDING TO CONFORM TO LATEST AWS STANDARDS.
 SURFACE TEXTURE: Ra 1.6
 TOLERANCES ARE NOT ACCUMULATIVE

REV	ASBY	QTY	ISSUING INFORMATION	DATE	SCALE

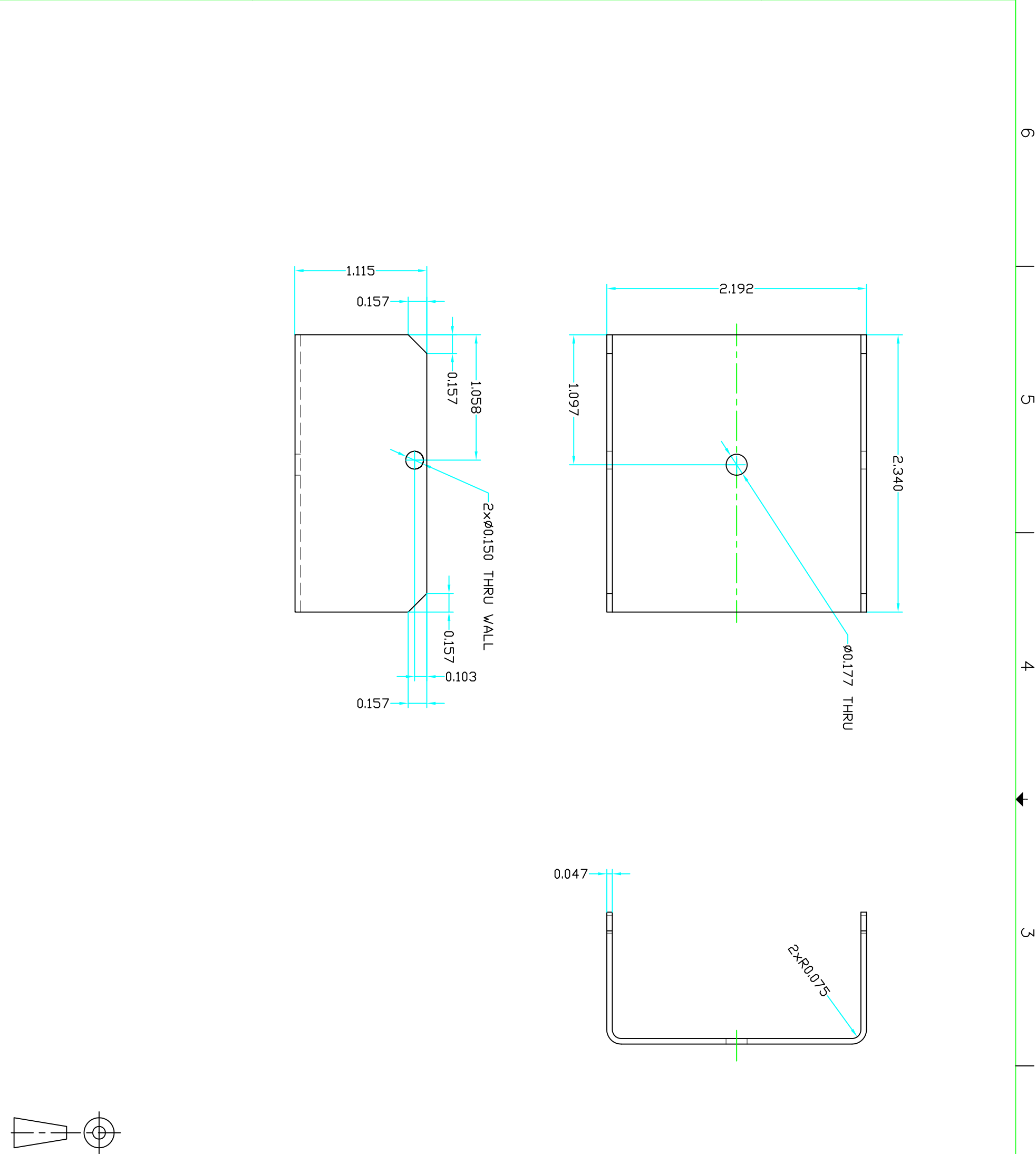

ATLAS
 BRANDEIS
 HIGH ENERGY
 PHYSICS
 LABORATORY
 NSW ALIGNMENT
 BCM
 COVER
 500.10.00.02
 SHEET
 1 OF 1
 REVISION
 A